

LEGEND

- | | |
|------------------------------------|--|
| 1 ROWLOCK CAP (ALTERNATING) | 4 FACE OF BUILDING |
| 2 BRICK | 5 HVAC UNIT |
| 3 CONC. SLAB | 6 OPENING IN WALL FOR AIRFLOW / DRAINABLE |

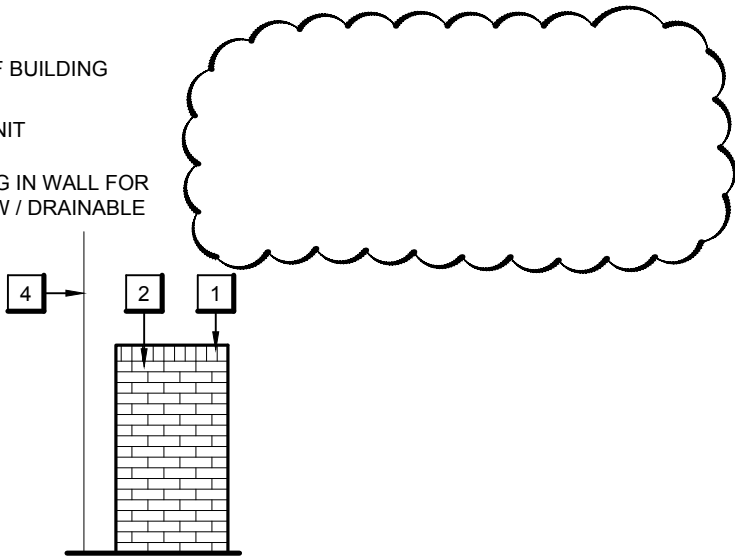

LEGEND

- | | |
|------------------------------------|--|
| 1 ROWLOCK CAP (ALTERNATING) | 4 FACE OF BUILDING |
| 2 BRICK | 5 HVAC UNIT |
| 3 CONC. SLAB | 6 OPENING IN WALL FOR AIRFLOW / DRAINABLE |

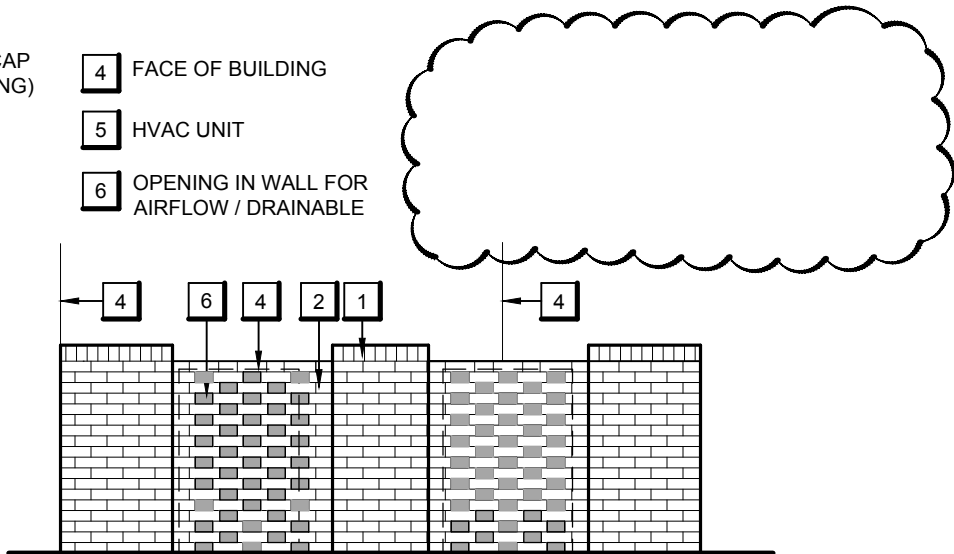

LEGEND

- | | |
|------------------------------------|--|
| 1 ROWLOCK CAP (ALTERNATING) | 4 FACE OF BUILDING |
| 2 BRICK | 5 HVAC UNIT |
| 3 CONC. SLAB | 6 OPENING IN WALL FOR AIRFLOW / DRAINABLE |

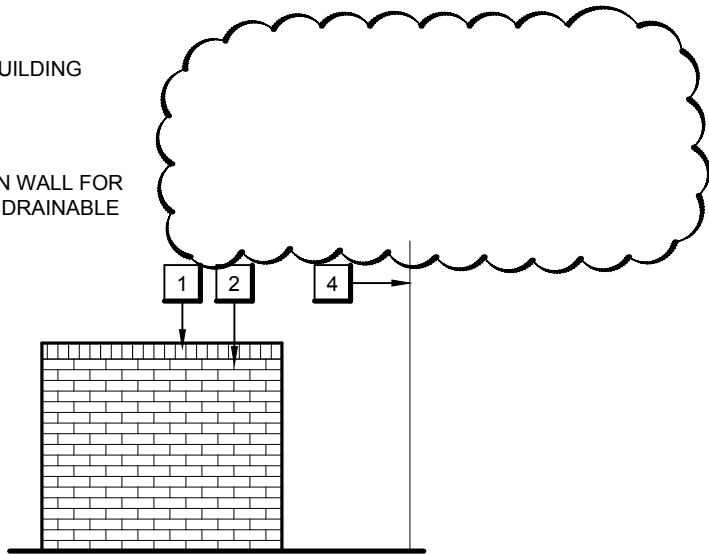

9B, 9C & 9D-A6.3 HVAC SCREEN WALL ELEVATIONS

1/4" = 1'-0"



Job No: 10036
BB&T HOLLY SPRINGS
 LOCATION: HOLLY SPRINGS, NC
 DATE: 12/16/10

